

Delta Force (1998) – Fixes Guide

Installation & Setup

Obtain the Game

1. Buy the game on Steam or use your own copy or disc. Download and install it.
-

Locate the Game Folder

2. Open your game's folder/directory on your PC.

Example:

C:\Program Files (x86)\Steam\steamapps\common\Delta Force
(or wherever you manually installed it)

Note:

If you follow this guide's steps and still have issues, it's highly recommended to install the game elsewhere than **Program Files**.

See the **Additional Notes** section at the bottom of this document for further instructions for Steam users.

Download Required Files

3. Go to: [NovaHQ.net](#) → [Files](#) → [Delta Force 1](#) and download the file package shown in the screenshot below.

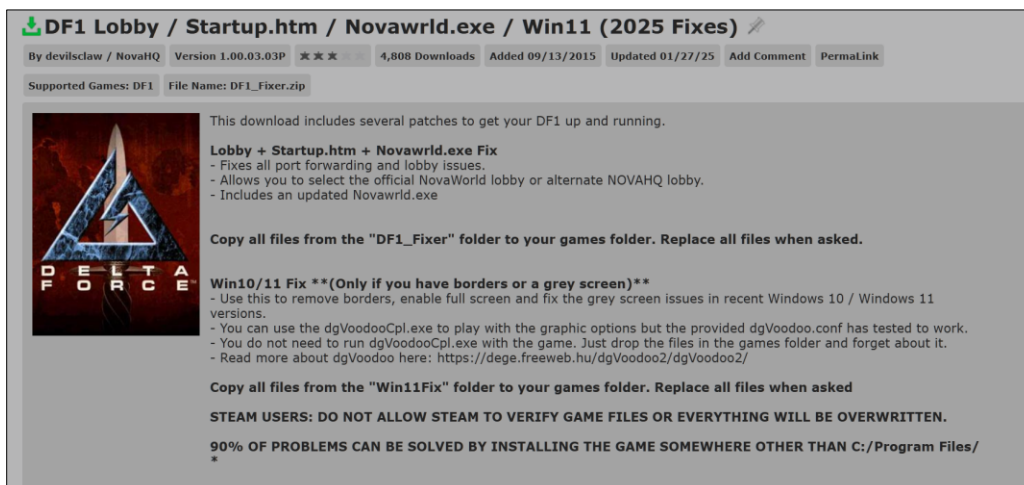

The screenshot shows a file download page for 'DF1 Lobby / Startup.htm / Novawrld.exe / Win11 (2025 Fixes)'. The page includes a download button, a file name field, and a description of the download. The description states that the download includes several patches to get the DF1 up and running, including a lobby fix, a Win10/11 fix, and a Steam users note. It also mentions that 90% of problems can be solved by installing the game somewhere other than C:/Program Files/.

DF1 Lobby / Startup.htm / Novawrld.exe / Win11 (2025 Fixes)

By devilsclaw / NovaHQ Version 1.00.03.03P ★ ★ ★ 4,808 Downloads Added 09/13/2015 Updated 01/27/25 Add Comment PermaLink

Supported Games: DF1 File Name: DF1_Fixer.zip

This download includes several patches to get your DF1 up and running.

Lobby + Startup.htm + Novawrld.exe Fix

- Fixes all port forwarding and lobby issues.
- Allows you to select the official NovaWorld lobby or alternate NOVAHQ lobby.
- Includes an updated Novawrld.exe

Copy all files from the "DF1_Fixer" folder to your games folder. Replace all files when asked.

Win10/11 Fix **(Only if you have borders or a grey screen)**

- Use this to remove borders, enable full screen and fix the grey screen issues in recent Windows 10 / Windows 11 versions.
- You can use the dgVoodooCpl.exe to play with the graphic options but the provided dgVoodoo.conf has tested to work.
- You do not need to run dgVoodooCpl.exe with the game. Just drop the files in the games folder and forget about it.
- Read more about dgVoodoo here: <https://dege.freeweb.hu/dgVoodoo2/dgVoodoo2/>

Copy all files from the "Win11Fix" folder to your games folder. Replace all files when asked

STEAM USERS: DO NOT ALLOW STEAM TO VERIFY GAME FILES OR EVERYTHING WILL BE OVERWRITTEN.

90% OF PROBLEMS CAN BE SOLVED BY INSTALLING THE GAME SOMEWHERE OTHER THAN C:/Program Files/

*

Downloaded items:

 DF1_Fixer	File folder
 Win11Fix	File folder
 Readme.txt	Text Document

Apply DF1 Fixer Files

4. In the **DF1_Fixer** folder, copy and paste **and REPLACE ALL** of these files into your game's directory that you located before:

C:\Program Files (x86)\Steam\steamapps\common

(or wherever you manually installed it)

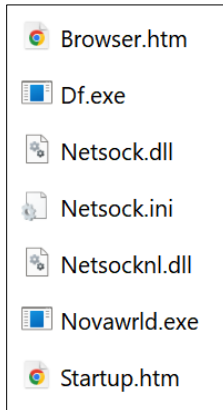

Apply Windows 11 Fix (If Applicable) *(grey screen, interlacing issues, or a Windows border bar displayed):*

- In the **Win11Fix** folder, copy and paste the files into your game's directory:

C:\Program Files (x86)\Steam\steamapps\common\Delta Force

(or wherever you manually installed it)

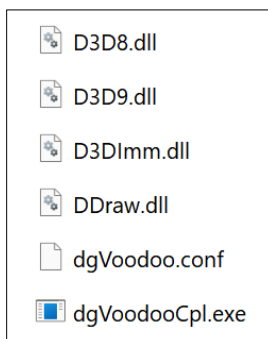

Once these files are placed in your game's directory, it should resolve most common issues such as:

- Game freezes
- Being stuck in 4:3 aspect ratio (not widescreen)
- Other common compatibility problems

Windows Firewall

If you encounter a **black screen and game freeze** upon manually selecting a game server, ensure that **Delta Force is allowed through your firewall**.

Firewall Configuration Steps

1. Press **Windows Key** → Search for **Windows Firewall** → Click **Windows Defender Firewall**
2. Click **Allow an app or feature through Windows Defender Firewall**

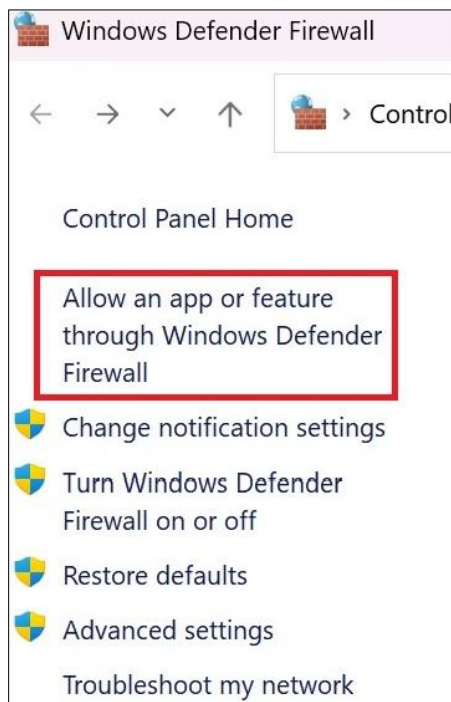

3. Click **Change Settings**

Allow apps to communicate through Windows Defender Firewall

To add, change, or remove allowed apps and ports, click Change settings.

[What are the risks of allowing an app to communicate?](#)

 Change settings

4. Search for “df” or “Delta Force 1” and ensure **Private** and **Public** networks are checkmarked and allowed.

(If you know your LAN connection is set to private, checkmarking just Private should be enough.)

Allowed apps and features:		
Name	Private	Public
<input checked="" type="checkbox"/> df	<input checked="" type="checkbox"/>	<input checked="" type="checkbox"/>

How to Play

1. Launch **Delta Force 1.exe**

NOTE:

If you purchased the game on Steam, you **DO NOT** need to run Steam each time to play Delta Force.

Simply go to your df.exe file directory:

C:\Program Files (x86)\Steam\steamapps\common\Delta Force

Locate the df.exe file, right-click it, select **(More options) → Create Shortcut**.

It may be at the bottom of your file directory.

Click and drag the shortcut to your desktop.

2. Select **Choose Soldier** and edit your player name.
3. Go to **Settings** and adjust your keybinds and mouse sensitivity.
Most people prefer the **WASD** keys instead of the arrow keys for movement.

4. Click **Multiplayer Game** → **Play a Multiplayer Game**

- Connection Type: **Novaworld**
- Click **Join**

5. Select the **NOVAHQ** lobby.

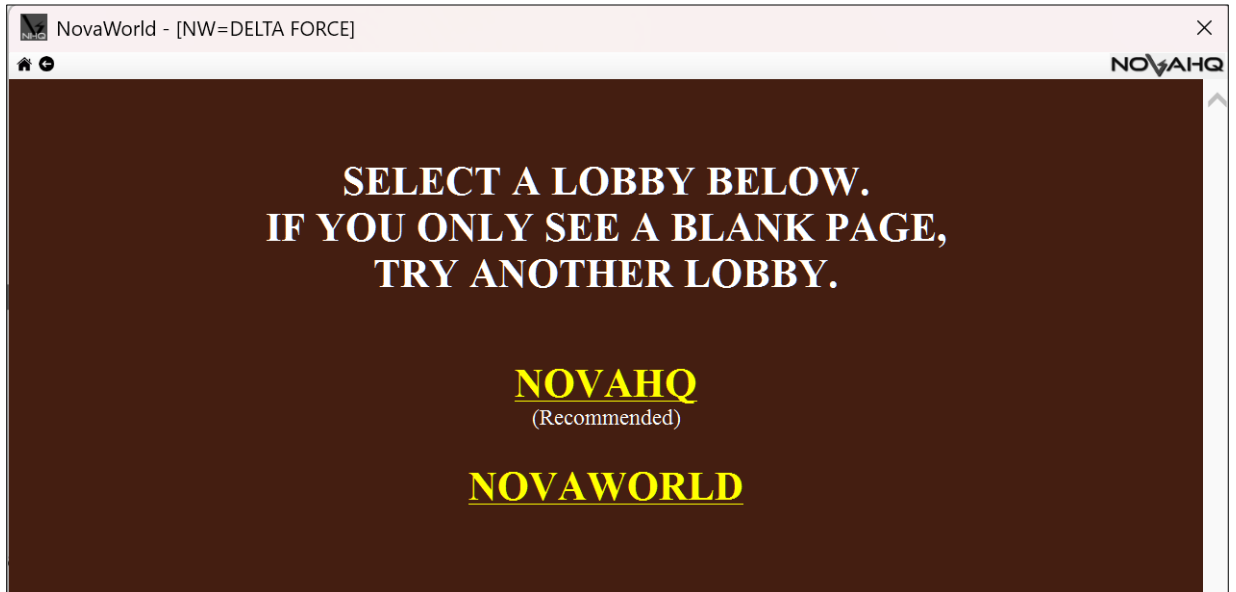

6. Select a server.

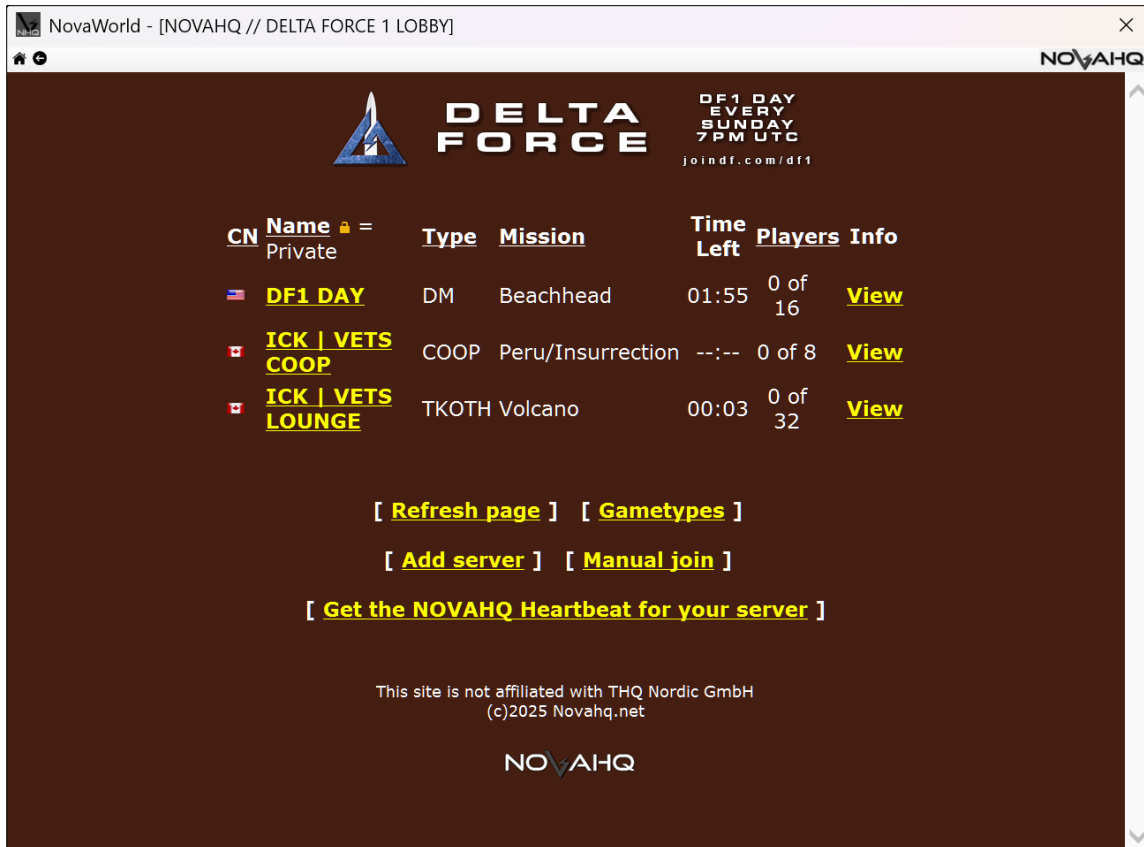

7. ENJOY!!!!

Additional Notes

If you still encounter issues, it's highly recommended to install the game to a directory other than **Program Files**.

For example:

- C:\NovaLogic\Delta Force
- C:\Games\Delta Force

To accomplish this with the Steam version, download the [Steam Library Setup tool](#) and follow the instructions.

You should then be able to pick a different install location for your Steam games.

- Note: You should be able to verify the download locations in Steam under **Settings** → **Storage** (instead of Downloads as the article mentions).

- If you continue to have issues getting the game to run correctly, contact me using the form at:
<https://icksquad.net/contact/>
and I'll see if I can help out!
- While playing, check out this page for a list of commands to use in the chat window to see your stats, among other options:
<https://icksquad.net/commands/>
- I hope this was helpful! Cheers.

ICK-SniperShot

<https://icksquad.net/>